

LEGEND

• FOUND IRON ROD

PLAT OF SURVEY

A PARCEL OF LAND LOCATED IN THE NORTHWEST 1/4 OF THE NORTHEAST 1/4 OF SECTION 29 IN TOWNSHIP 2 NORTH, RANGE 17 EAST, IN THE TOWN OF GENEVA, WALWORTH COUNTY, WISCONSIN.

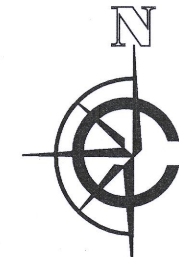

0 30 60 Feet
SCALE: 1"=30'

NOTE:

1. BASIS OF BEARING: THE WISCONSIN STATE PLANE COORDINATE SYSTEM, NAD-83, SOUTH ZONE.
2. FIELD WORK COMPLETED JUNE 17, 2020
3. BUILDING SURVEYED TO THE EXTERIOR OF SIDING.
4. WISCONSIN DNR SURFACE WATER MAP INDICATES WETLAND SOIL TYPE ON OR NEAR THE SOUTHEAST CORNER OF UNIT 16-06.
5. FIELD CREW CHIEF: LOGAN RANDLE

LEGAL DESCRIPTION:

A PARCEL OF LAND LOCATED IN THE NORTHWEST 1/4 OF THE NORTHEAST 1/4 OF SECTION 29 IN TOWNSHIP 2 NORTH, RANGE 17 EAST, IN THE TOWN OF GENEVA, WALWORTH COUNTY, WISCONSIN, MORE PARTICULARLY DESCRIBED AS:

UNIT 16-06 OF GENEVA NATIONAL CONDOMINIUM NO. 16

SURVEY ORDERED BY:

KEEFE REAL ESTATE

PROPERTY ADDRESS:

GENEVA NATIONAL AVE
LAKE GENEVA, WI 53147

SURVEYOR:

PAUL H. VAN HENKELUM, PLS
CARDINAL ENGINEERING LLC

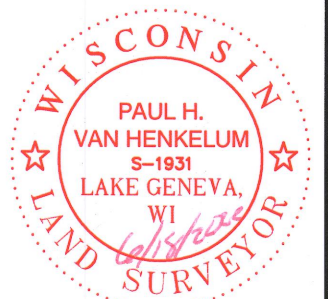

"I HEREBY CERTIFY THAT I HAVE SURVEYED THE ABOVE DESCRIBED PROPERTY AND THE MAP IS A TRUE AND CORRECT REPRESENTATION OF ITS EXTERIOR BOUNDARIES AND SHOWS THE SIZE AND LOCATION OF ALL VISIBLE STRUCTURES, APPARENT EASEMENTS AND ENCROACHMENTS, IF ANY."

Paul H. Van Henkelum
PAUL H VAN HENKELUM, PLS #1931

6/18/2020
DATE



CARDINAL ENGINEERING LLC
DESIGNING IN TRUE DIRECTIONS

PO BOX 281 - 1200 LA SALLE ST.
LAKE GENEVA, WI 53147
262-757-8776
CARDINALENGINEERINGWI.COM

DATE: 06/18/2020 JOB No. 20385
SHEET 1 OF 1

JGN 16-6

217-4672